

ERECTED
 TYPE
 FOUNDATION
 WALLS
 ROOF { TYPE
 PITCH
 HEATING

1903
 FRAME
 PILE HEADS
 2x6
 GABLE - SHINGLES
 $\frac{1}{3}$
 STOVES

FLOOR
 FINISH { INSIDE
 OUTSIDE
 CEILING HEIGHT
 LIGHTING
 SANITARY FACILITIES

$\frac{3}{4}$ " x $\frac{3}{4}$ " Y. P.
 $\frac{3}{4}$ " x $\frac{3}{4}$ " B.D.
 BOARDS & BATTENS - 1" x 6" DROP SPG
 11'-9"
 LAMPS
 OUTSIDE TOILETS
 RIVER DIV.
 ST. LOUIS
 STA. NO. T 11

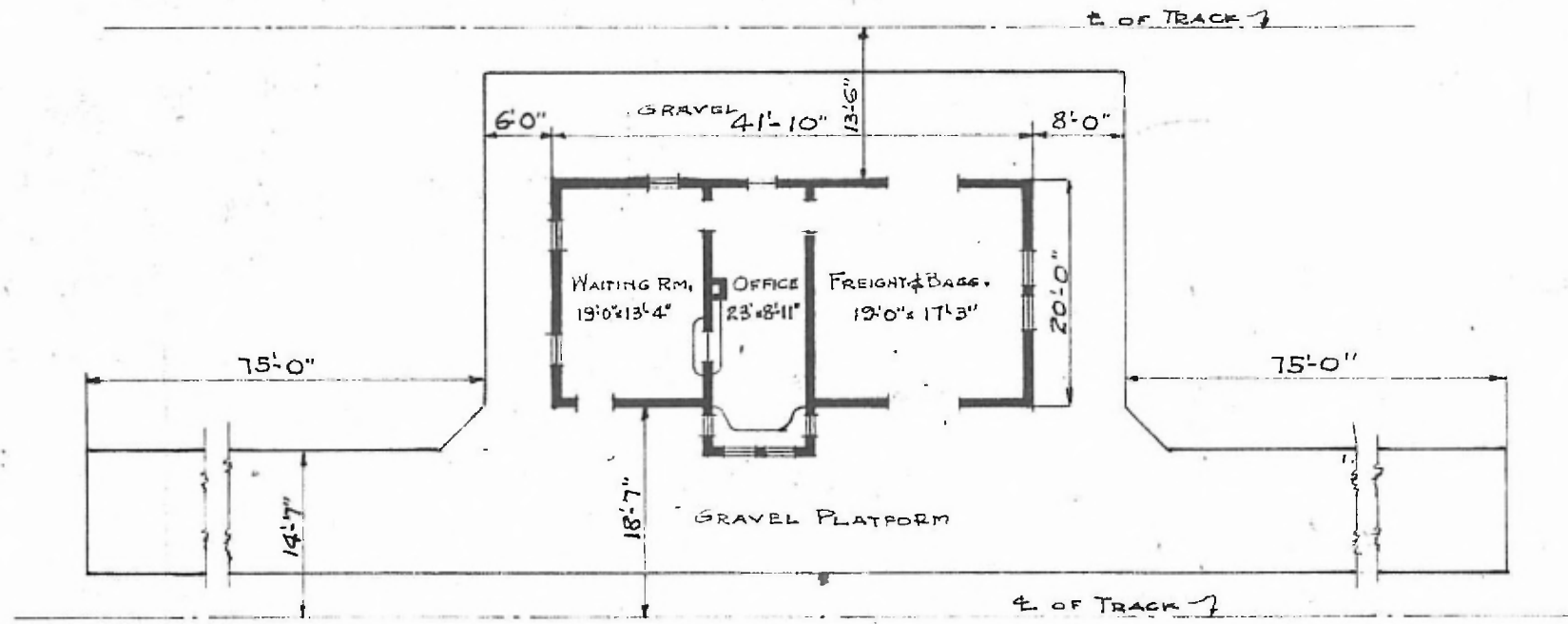

FLOOR PLAN
 SCALE: $\frac{1}{16}$ " = 1'-0"

COMBINATION STATION
 GRAVOIS, MO.

JULY 30, 1917.