

40

ERECTED 1903
 TYPE FRAME
 FOUNDATION PILE HEADS
 WALLS 2x6
 ROOF { TYPE GABLE SHINGLES
 PITCH 1/3
 HEATING STOVES

FLOOR
 FINISH { INSIDE
 OUTSIDE
 CEILING HEIGHT
 LIGHTING
 SANITARY FACILITIES

RIVER DIV. SUB
 CHAFFEE SUB
 STA. NO. T 227
 3"
 4x34" Y.P.
 4x34" BEEDED CEILING
 BOARDS & BATT. 1x6 DROP SIDING
 WAITING RM. = 11'-10" FR.T. RM. = 13'-4"
 OIL LAMPS
 OUTSIDE TOILETS.

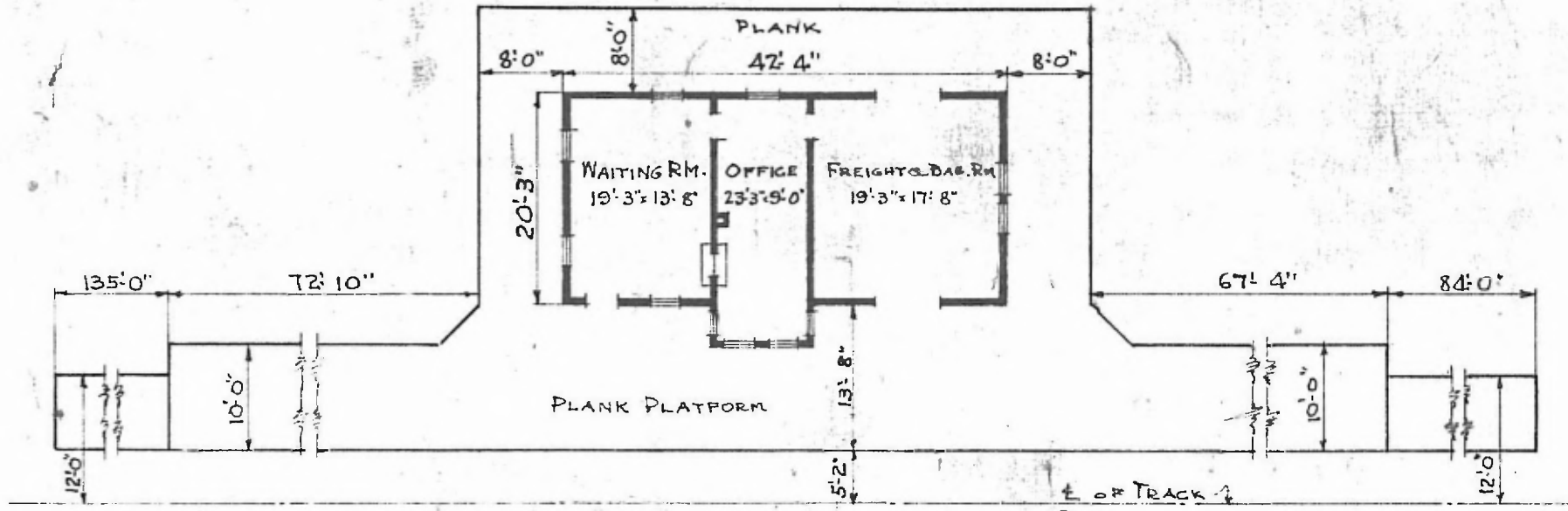

FLOOR PLAN
 SCALE: 1/16" = 1' 0"

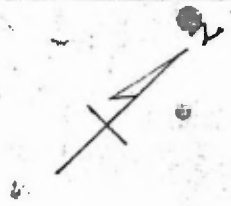

COMBINATION STATION
 HOLLAND, MO.

Oct. 8, 1919