

ERECTED	1915	FLOOR	CEMENT
TYPE	STUCCO · CEMENT BASE	FINISH { INSIDE	PLASTER
FOUNDATION	CONCRETE	{ OUTSIDE	CEMENT PLASTER
WALLS	12" HOLLOW TILE	CEILING HEIGHT	14'-0"
ROOF { TYPE	FLAT · COMPOSITION	LIGHTING	ELECTRIC
PITCH		SANITARY FACILITIES	INSIDE TOILETS
HEATING	STEAM		

EASTERN  
SPRINGFIELD  
STA No. 282

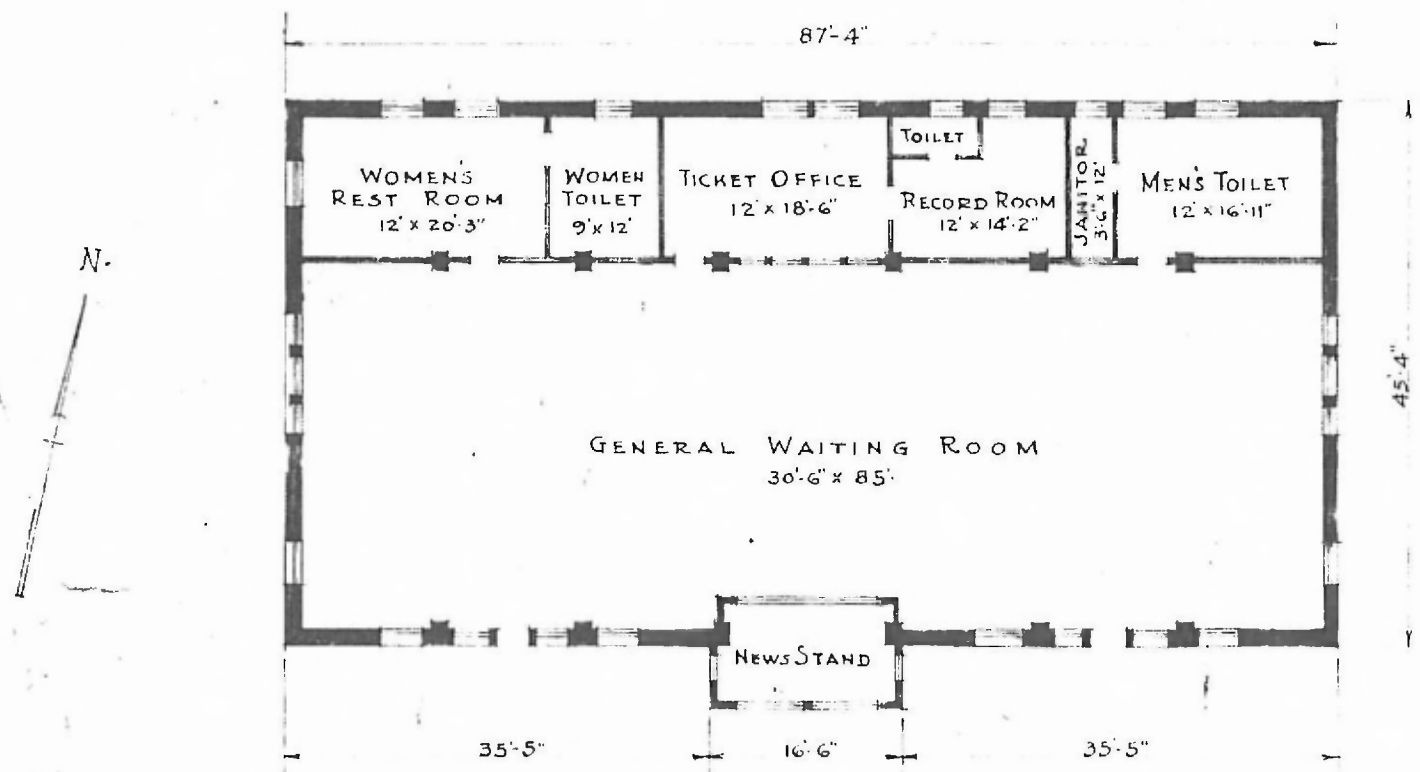

· PASSENGER · STATION · AT ·  
· MONETT · MO ·

· FLOOR · PLAN ·  
· SCALE: 1/16" = 1'-0" ·