

ERECTED 1891  
 TYPE. FRAME.  
 FOUNDATION FILL HEADS.  
 WALLS 2x6  
 ROOF { TYPE. GABLE. SHINGLE.  
 FITCH 1/3  
 HEATING STOVES.

FLOOR 7/8x3 1/4 PINE.  
 FINISH { INSIDE 7/8x3 1/4 BEADED.  
 OUTSIDE BOARDS & BATTENS.  
 CEILING-HEIGHT. 11'-4"  
 LIGHTING LAMPS.  
 SANITARY FACILITIES. OUTSIDE.

EASTERN DIV.  
 WEIRANON SUB  
 STA. No. 207

47

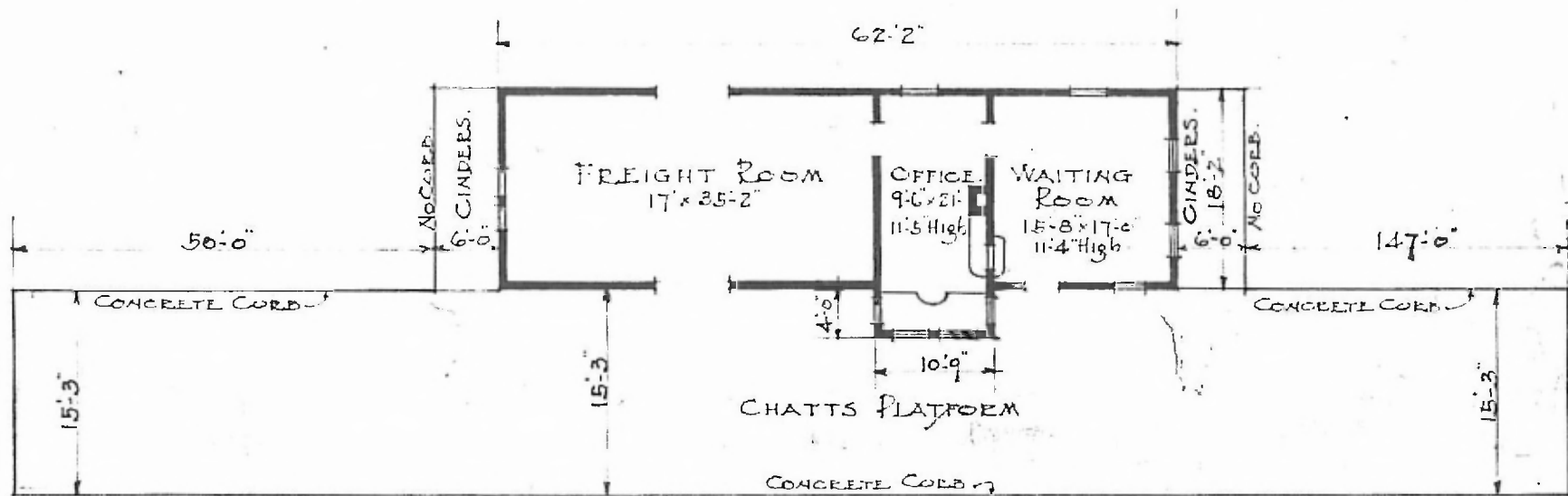

FLOOR PLAN.  
 SCALE 1/16" = 1'-0"



COMBINATION STATION  
 NIANGUA, MO.

DEC. 26. 1916.