

ERECTED 1906.
 TYPE: FRAME
 FOUNDATION: PILE HEADS.
 WALLS: 2"x6"
 ROOF { TYPE: GABLE, SHINGLE,
 { PITCH: 1/8.
 HEATING: STOVES.

FLOOR: 2"x8" Y. PINE
 FINISH { INSIDE: 3/4"x2 1/2" BO. CEILING.
 { OUTSIDE: BOARD & BATT.
 CEILING HEIGHT: 11'-2" FEEL EM 13'-1"
 LIGHTING: LAMPS.
 SANITARY FACILITIES: OUTSIDE TOILETS.

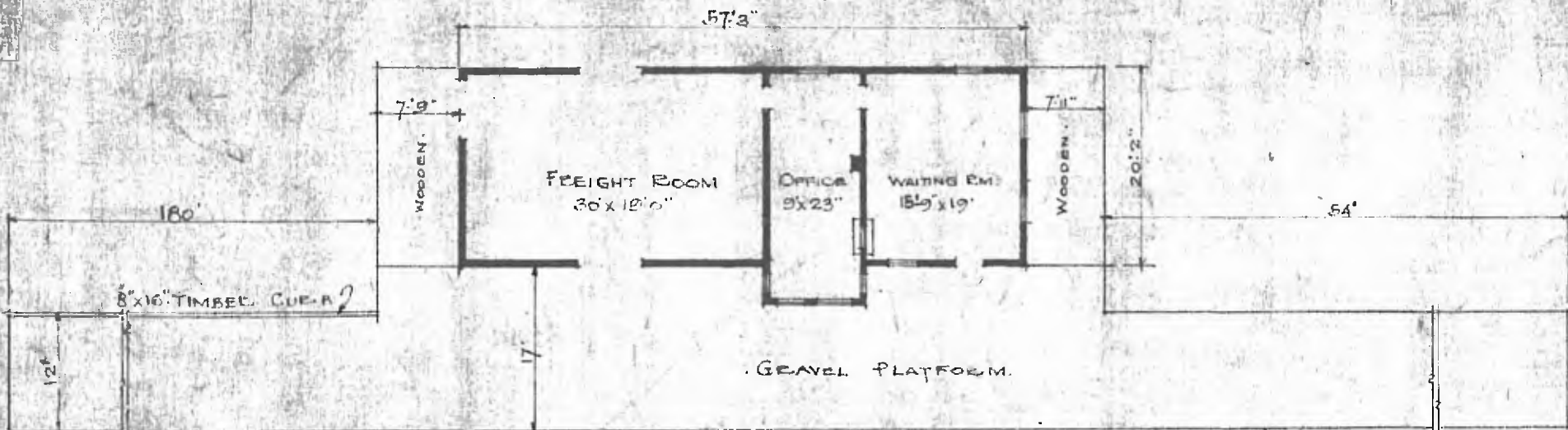

• FLOOR PLAN.
 • SCALE: 1/16" = 1'-0"

DIV: CENTRAL
 STA. No. 290
 STA. CALL = RD
 SUB. DM. FT. SMITH

• COMBINATION STATION AT
 • PURDY • MO.

• JULY 29, 1915.