

ERECTED. 1910.  
 TYPE. FRAME.  
 FOUNDATION. CONCRETE.  
 WALLS. 2x6"  
 ROOF { TYPE GABLE SHINGLES  
       PITCH 1/3  
 HEATING. STOVES.

FLOOR. MAPLE.  
 FINISH { INSIDE PLASTER.  
        OUTSIDE. DROP SIDING.  
 CEILING HEIGHT. 12'3"  
 LIGHTING. ELECTRIC.  
 SANITARY FACILITIES. OUTSIDE TOILETS.

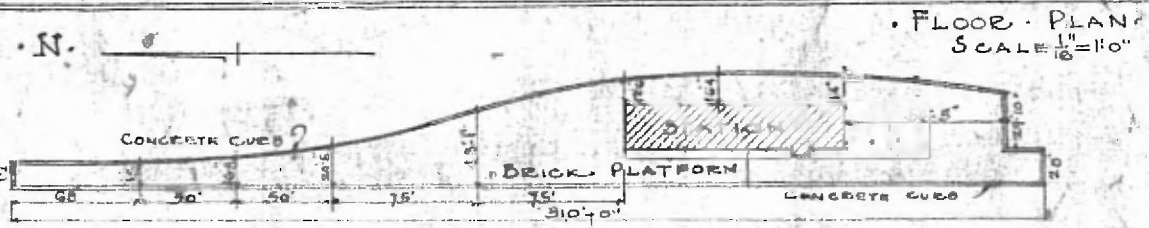
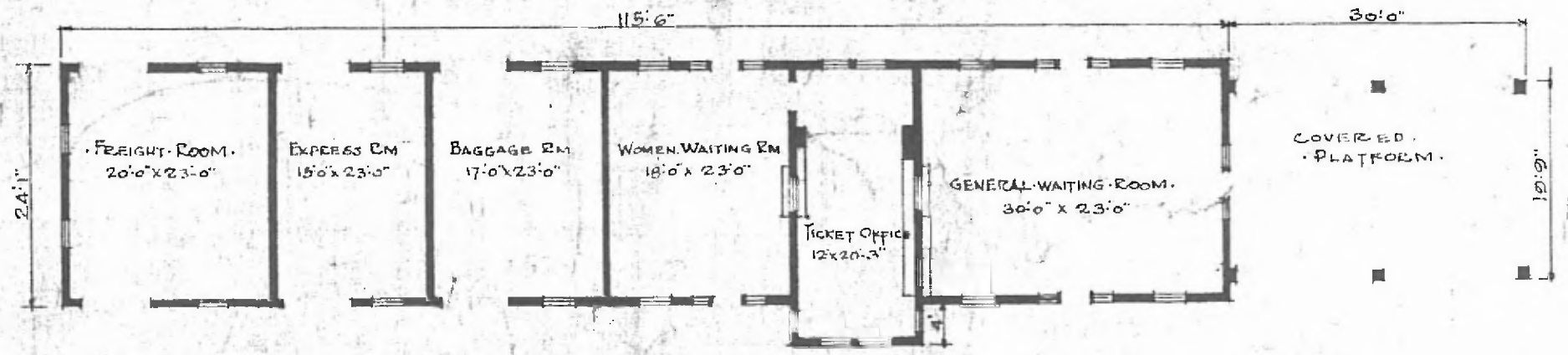

• PLATFORM DIAGRAM.  
 • SCALE. 1"=100'.

• FLOOR PLAN.  
 SCALE 1/16"=1'0"

DIV. CENTRAL  
 SUB-DIV. FT. SMITH.  
 STA. NO. 313

• COMBINATION STATION AT  
 • SELIGMAN MO.

JULY 26 1915