

4

ERECTED 1906  
 TYPE FRAME  
 FOUNDATION BLOCKS & PILES  
 WALLS 2" x 6"  
 ROOF TYPE GABLE - SHINGLES  
 PITCH 4  
 HEATING STOVES

FLOOR  
 FINISH { OUTSIDE  
 { INSIDE  
 CEILING  
 LIGHTING  
 SANITARY FACILITIES

7/8" x 3 1/2"  
 7/8" x 5 1/2" DROP SIDING  
 7/8" x 3 1/2" MATCH & BLEED  
 11' 3" HEIGHT W. ROOM - 10' 5" FREIGHT ROOM.  
 ELECTRIC  
 OUTSIDE TOILETS

SOUTHERN DIV.  
 WILLOW SPRINGS SUB  
 STA. NO. C 237

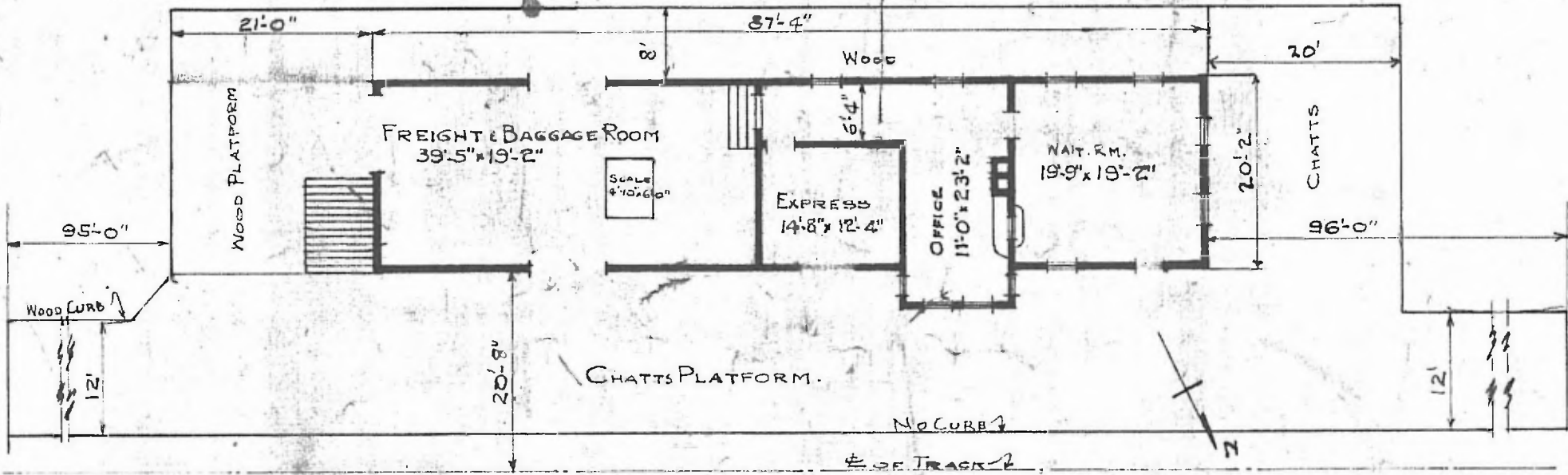

FLOOR PLAN  
 SCALE: 1/16" = 1'-0"

COMBINATION STATION AT  
 SEYMOUR, MO.

JULY 29, 1916