

RIVER DIV
CHAFFER SUB
STA. NO. 724

39

ERECTED 1903
 TYPE FRAME
 FOUNDATION PILE HEADS
 WALLS 2x6
 ROOF { TYPE GABLE SHINGLES
 PITCH 1/3
 HEATING STOVES

FLOOR 3/4" x 3/4" Y. P.
 FINISH { INSIDE 1 1/2" x 3/4" BEEDED CEILING
 OUTSIDE BOARDS & BATT - 1" x 6" DROPSIDING
 CEILING HEIGHT WAIT. RM. = 12'-7" - FR. RM. = 13'-6"
 LIGHTING OIL LAMPS
 SANITARY FACILITIES OUTSIDE TOILETS

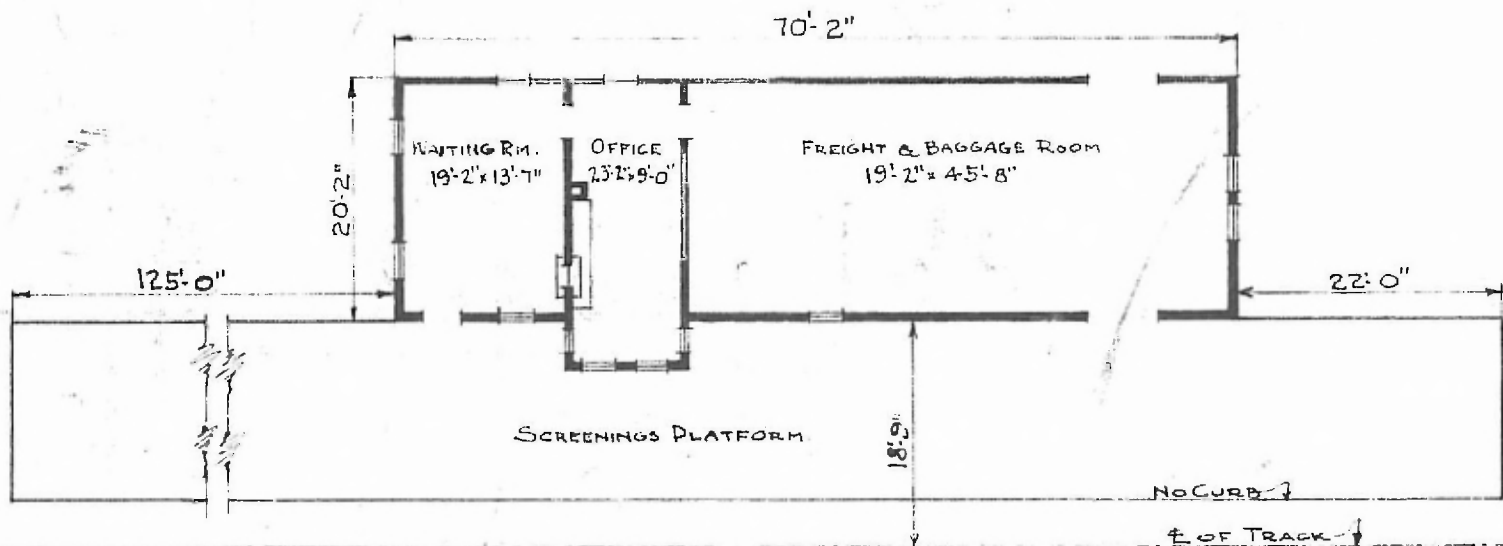

FLOOR PLAN
 SCALE: 1/16" = 1'-0"

COMBINATION STATION
 STEELE, MO.

OCT. 8, 1919