

ERECTED 1915  
 TYPE. FRAME.  
 FOUNDATION CONCRETE.  
 WALLS 2" x 6"  
 ROOF { TYPE. HIP. SHINGLE.  
 PITCH 9 1/2" PER FT.  
 HEATING STOVES.

FLOOR 7/8" x 3 1/4" PINE.  
 FINISH { INSIDE. 7/8" x 3 1/4" Y. JOINT.  
 OUTSIDE. DROP SIDING.  
 CEILING HEIGHT. 11'-6"  
 LIGHTING LAMPS.  
 SANITARY FACILITIES. OUTSIDE.

EASTERN DIV.  
 ROLLA SUB  
 STA. NO. 57

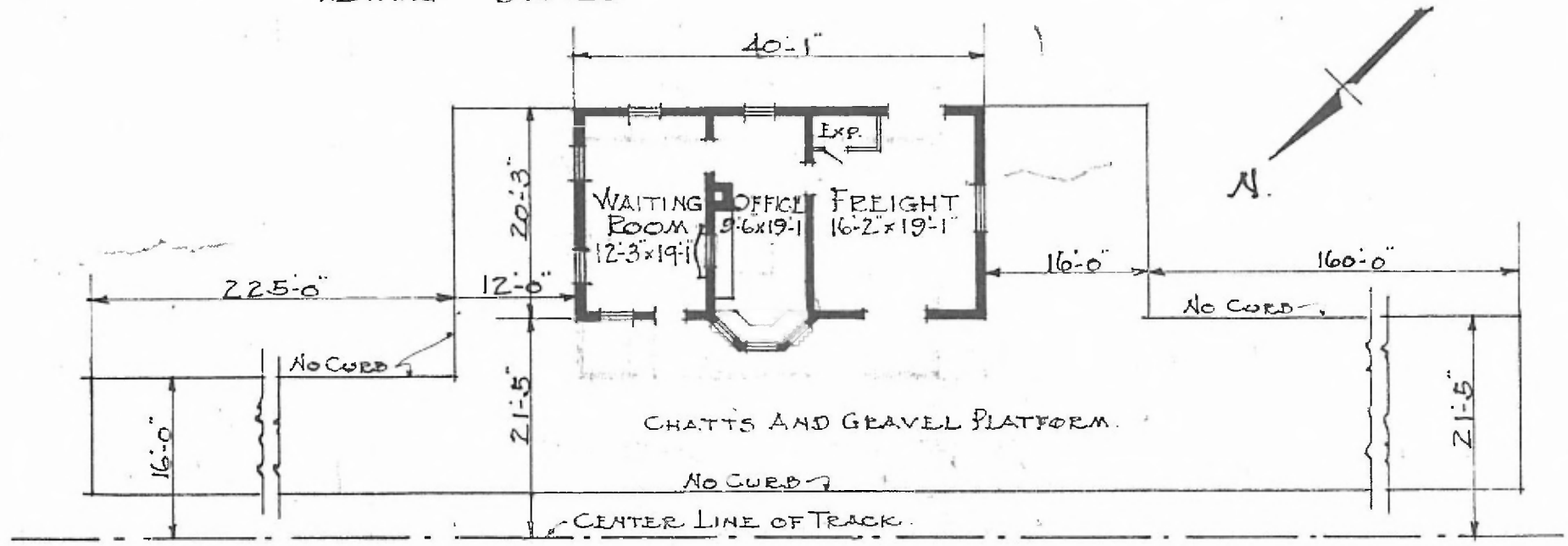

FLOOR PLAN.  
 SCALE 1" = 1'-0".

JAN. 18. 1917.

PASSENGER STATION  
 ANACONDA, MO.