

ERECTED: 1894
 TYPE: FRAME
 FOUNDATION: PILE HEADS
 WALLS: 2"x6"
 ROOF: TYPE: GABLE SHINGLES
 PITCH: 3
 HEATING: STOVES

FLOOR: $\frac{3}{4}$ " x $3\frac{1}{4}$ "
 FINISH: (INSIDE) $\frac{3}{4}$ " x $5\frac{1}{4}$ " M. & B.
 (OUTSIDE)
 CEILING HEIGHT: 13'-0"
 LIGHTING: OIL LAMPS
 SANITARY FACILITIES: OUTSIDE TOILET

NORTHERN DIV.
 ACTON SUB
 STA. No 5147

63

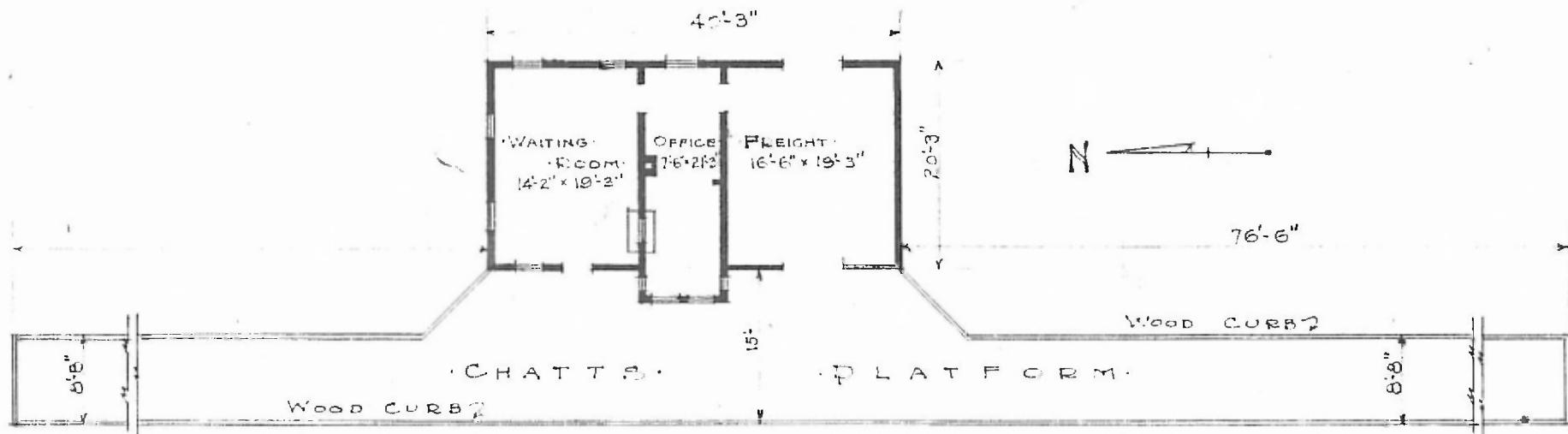

FLOOR PLAN
 SCALE $\frac{1}{16}$ " = 1'-0"

COMBINATION STATION
 ASBURY MO.

JUNE 18, 1915