

SECOND FLOOR PLAN

NORTHERN DIV
 CARTRIDGE SUB
 STATION F. 328
 ERECTED 1874
 TYPE FRAME
 FOUNDATION PILE HEADS
 WALLS 2" x 6"
 ROOF TYPE - GABLE SHINGLES
 PITCH 1/4
 HEATING STOVES
 FLOOR 7/8" x 5 1/4"
 FINISH { INSIDE - 7/8" x 3 1/4" M. & B. - WAINSCOT 46"
 OUTSIDE - 1" x 12" BOARDS & BATTENS
 CEILING HEIGHT - 11' - 11" - 2ND FLOOR = 8' 0"
 LIGHTING ELECTRIC
 SANITARY FACILITIES - OUTSIDE TOILET

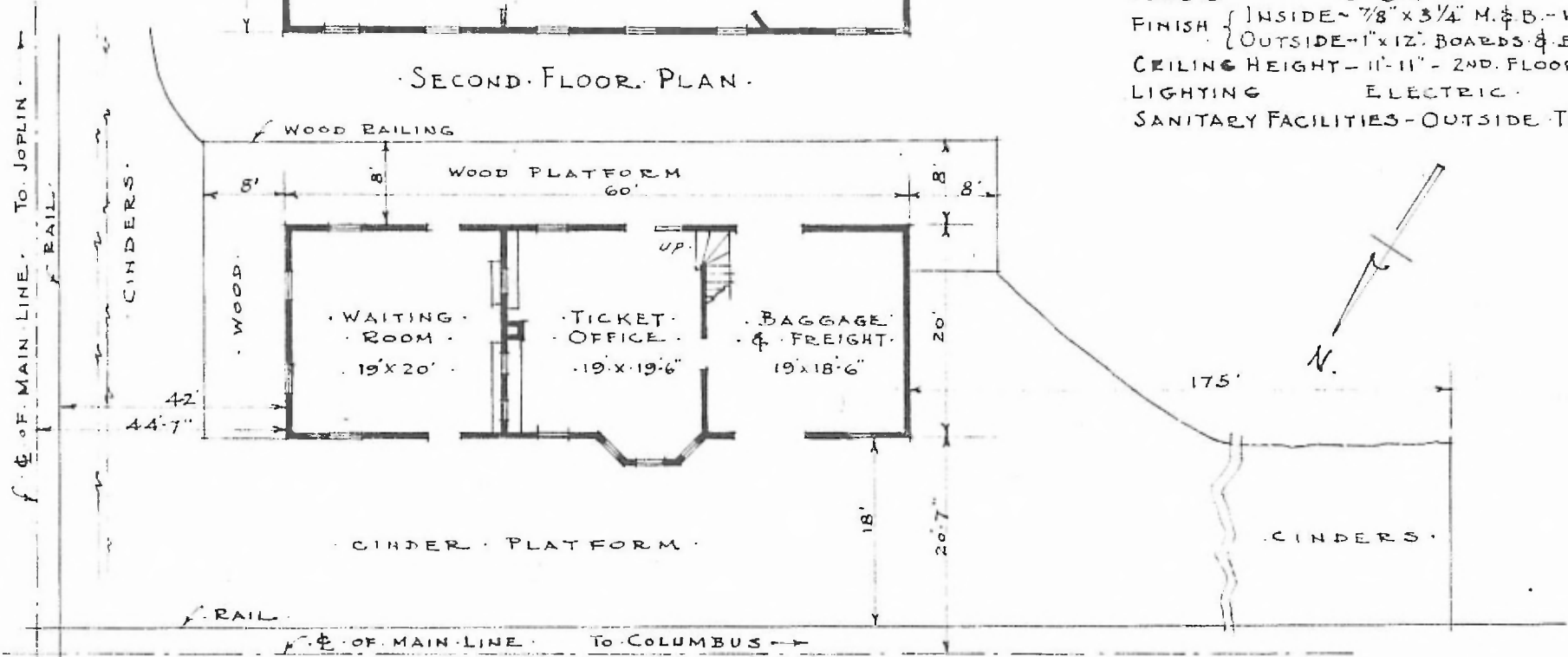

FIRST FLOOR PLAN

PASSENGER STATION AT
 CARL JCT. MO.

SCALE: 1/16" = 1'-0"

JUNE 7 1915