

ERECTED 1899
 TYPE FRAME
 FOUNDATION PILE HEADS
 WALLS 2'x6"
 ROOF { TYPE - GABLE. SHINGLES.
 PITCH - 1/3
 HEATING STOVES

FLOOR 3/4" x 3/4" Y. PINE
 FINISH { INSIDE
 OUTSIDE
 CEILING HEIGHT 11'-7" FREIGHT ROOM 10'-4"
 LIGHTING OIL LAMPS
 SANITARY FACILITIES - OUTSIDE TOILETS.

EASTERN DIV.
 CLINTON SUB
 STA. NO. D124

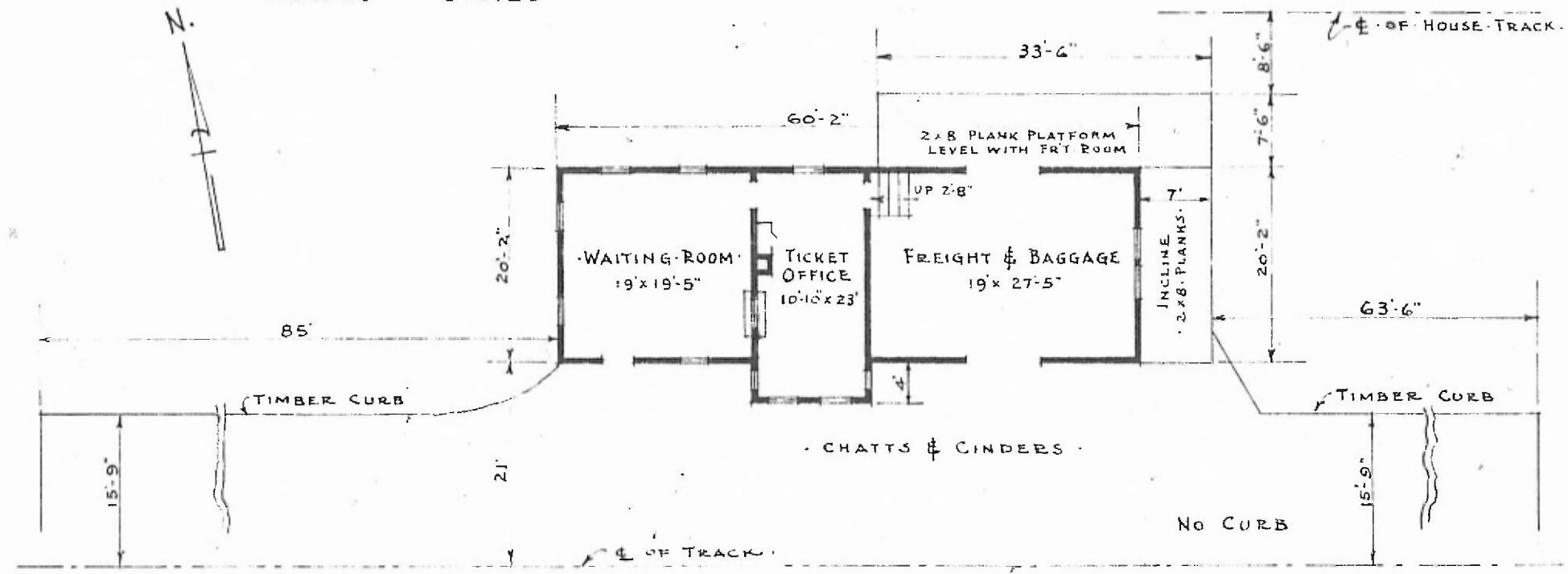

FLOOR PLAN
 SCALE: 1/16" = 1'-0"

PASSENGER STATION AT
 GERSTER MO.