

62

ERECTED 1890  
 TYPE FRAME  
 FOUNDATION PILES  
 WALLS 2x4  
 ROOF { TYPE GABLE-SHINGLES  
 PITCH  $\frac{3}{4}$   
 HEATING STOVES

FLOOR  $\frac{7}{8} \times 3\frac{1}{4}$ "  
 FINISH { INSIDE  $\frac{7}{8} \times 3\frac{1}{4}$ " M.&B.  
 OUTSIDE BOXING-DROPSIDING  
 CEILING HEIGHT 11'-4"  
 LIGHTING OIL  
 SANITARY FACILITIES OUTSIDE TOILETS

RIVER DIV.  
 HOXIE SUB  
 STA. No. TA 203

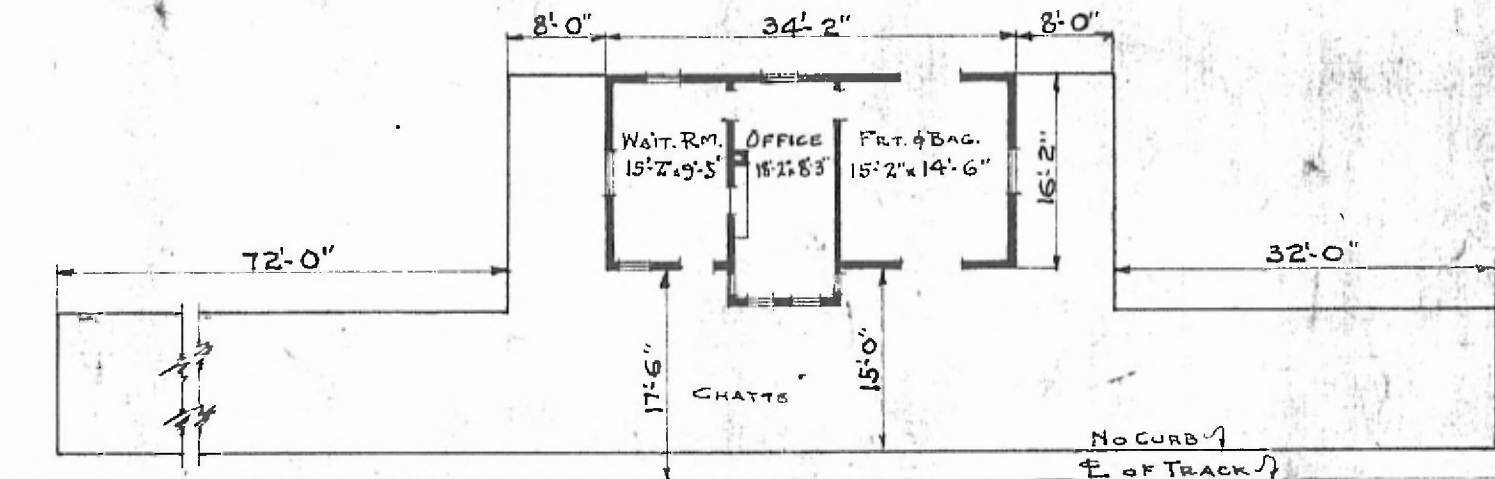

FLOOR PLAN  
 SCALE:  $\frac{1}{16}'' = 1'-0''$

COMBINATION STATION  
 HARVIELL, MO.

Aug. 14, 1918