

ERECTED 1880.  
 TYPE FRAME.  
 FOUNDATION PILE HEADS.  
 WALLS 2x6"  
 ROOF TYPE SHINGLES.  
 PITCH 1/3.  
 HEATING STOVES.

FLOOR 3/4 x 3/4".  
 FINISH { INSIDE 3/4 x 3/4"  
 OUTSIDE BOARDS & BATTS.  
 CEILING HEIGHT 10'-10" FRT. 11'-4".  
 LIGHTING LAMPS.  
 SANITARY FACILITIES OUTSIDE TOILETS.

NORTHERN DIV.  
 ST GROVE SUB  
 STA. NO. C132

19

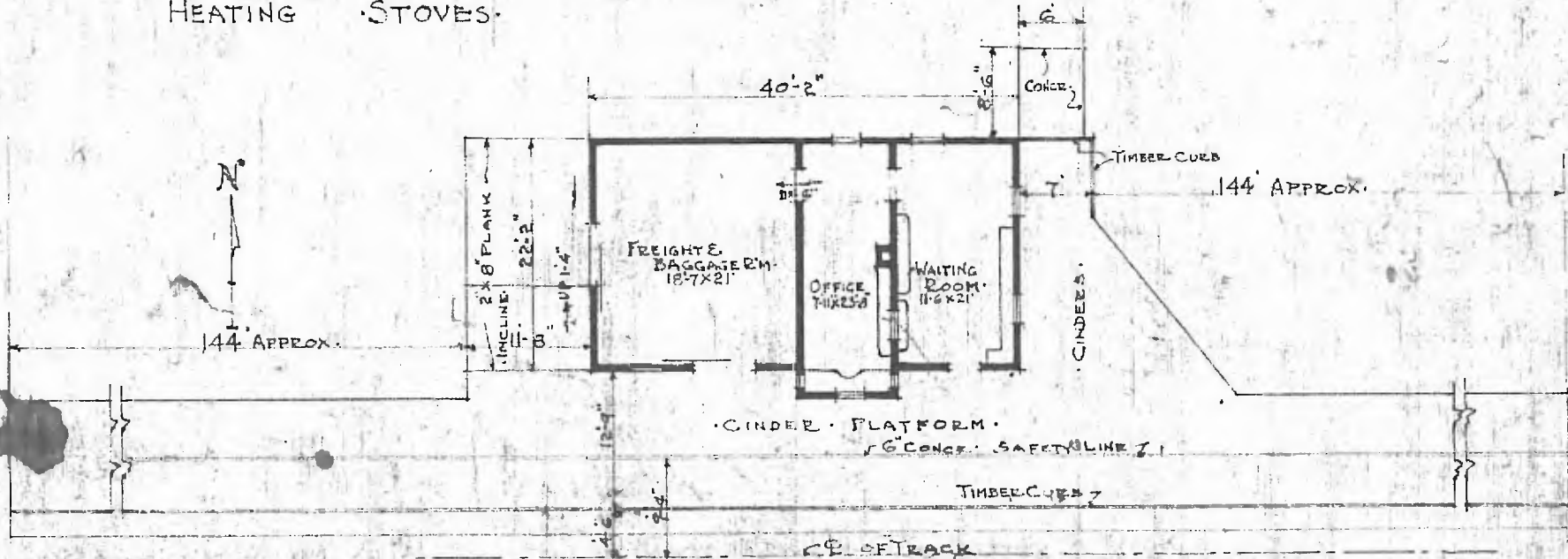

FLOOR PLAN OF STATION.  
 SCALE 1/8" = 1'-0"

PASSENGER STATION  
 ANTHA MO.