

ERECTED 1915.
 TYPE FRAME.
 FOUNDATION CONCRETE.
 WALLS 2" x 6".
 ROOF { TYPE. HIP. SHINGLE.
 PITCH 9/2 PER FOOT.
 HEATING STOVES.

FLOORS. 7/8 x 3 1/4 PINE.
 FINISH { INSIDE 7/8 x 3 1/4 V. JOINT
 OUTSIDE DROP SIDING
 CEILING HEIGHT 11'-6"
 LIGHTING LAMPS.
 SANITARY FACILITIES OUTSIDE.

107

EASTERN RAIL
 LEISANON SUB
 STA. NO. 124

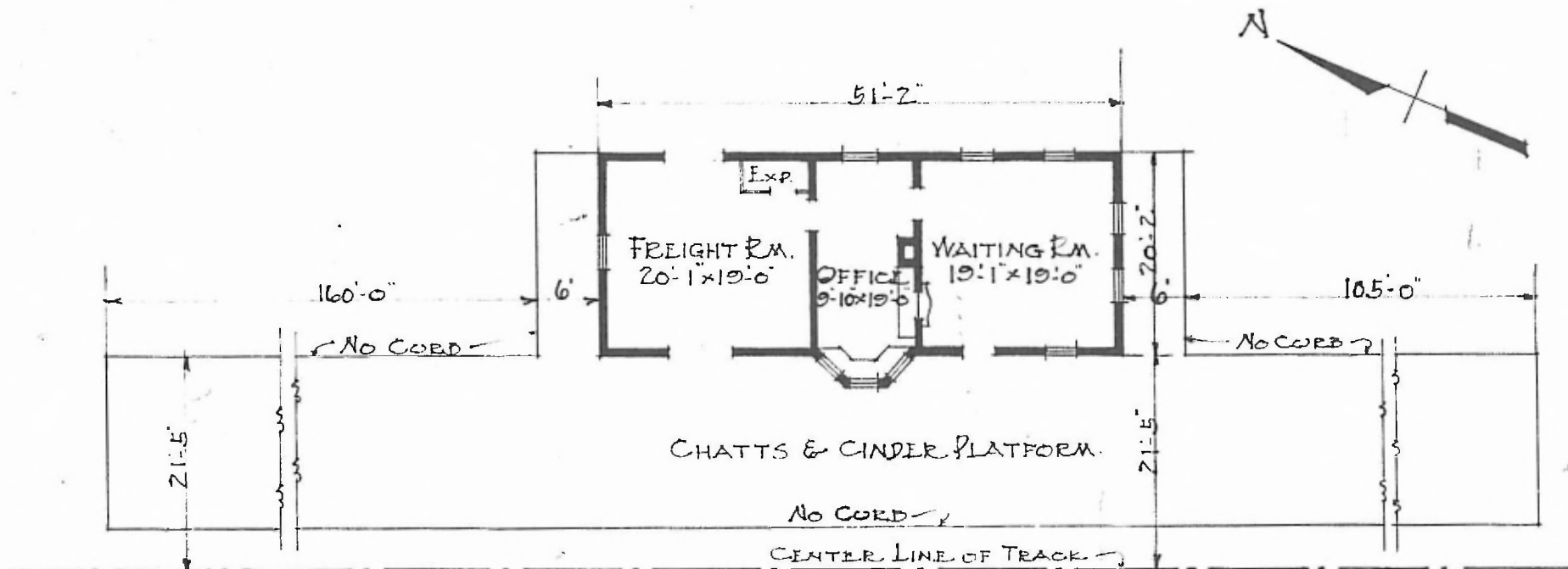

FLOOR PLAN.
 SCALE = 1/16" = 1'-0".

PASSENGER STATION.
 JEROME, MO.

JAN. 9. 1917