

106

ERECTED TYPE FRAME. FOUNDATION PILE HEADS. ROOF TYPE GABLE. READY BFG. CEILING HEIGHT. 7'-6". LIGHTING LAMPS.

HEATING STOVES. FINISH (INSIDE 1/8" x 3/4" BEADED. OUTSIDE BOARDS & BATTONS. SANITARY FACILITIES. OUTSIDE.

EASTERN DIV. ROLLING SUB. STA. NO 95

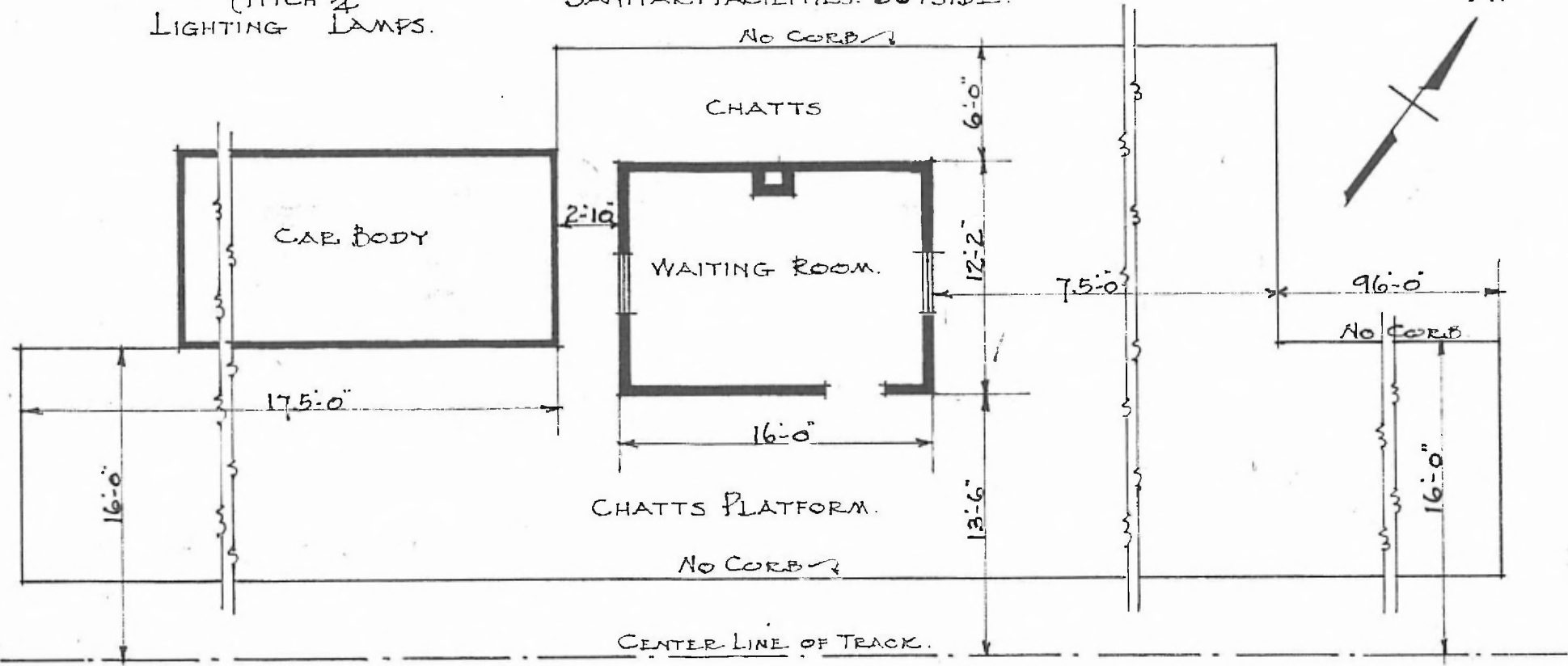

FLOOR PLAN. SCALE = 1/8" = 1'-0".

PASSENGER STATION. KNOBVIEW, MO. (ROSATTI)

JAN. 22. 1917.