

ERECTED.
 TYPE: FRAME
 FOUNDATION: PILE HEADS.
 WALLS: 2" x 6"
 ROOF: TYPE: GABLE, SHINGLES.
 PITCH: $\frac{1}{2}$
 HEATING: STOVES

FLOOR: 1" x 3/4" Y.P.
 FINISH: INSIDE 3/4" M. & B.
 OUTSIDE
 CEILING HEIGHT: 11'-1"
 LIGHTING: ELECTRIC
 SANITARY FACILITIES: OUTSIDE TOILETS.

SOUTHERN DIV
 WILLOW SPRING S.D.
 97A. No. C331

15

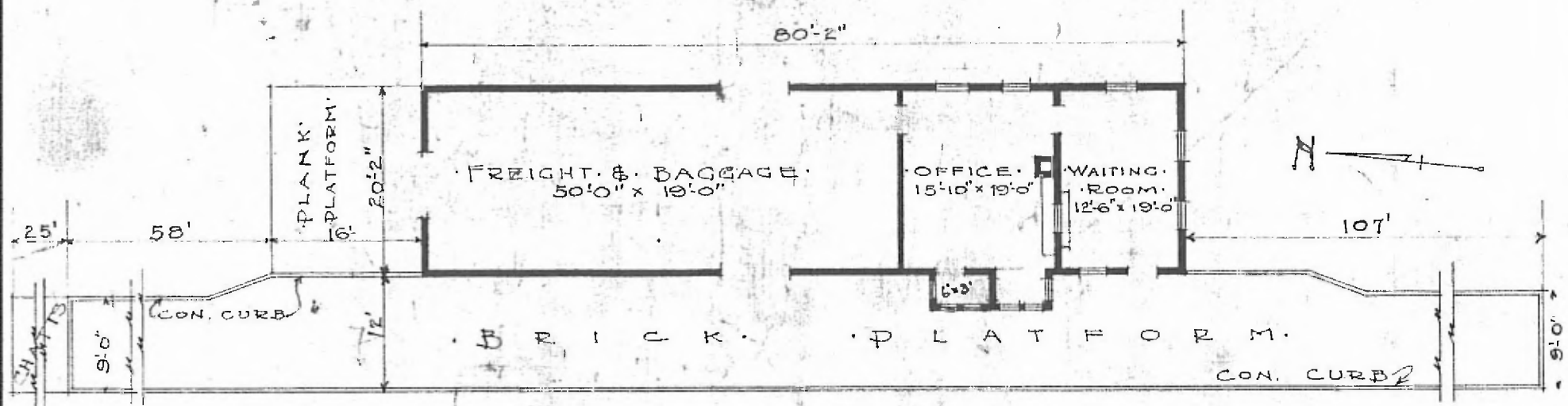

FLOOR PLAN.
 SCALE $\frac{1}{16}'' = 10''$

COMBINATION STATION.
 KOSHKONONG MO.

AUG. 3, 1916.