

32

ERECTED 1903
 TYPE FRAME
 FOUNDATION PILES HEADS
 WALLS 2x6
 ROOF { TYPE GABLE SHINGLES
 PITCH 1/3
 HEATING STOVES

FLOOR
 FINISH { INSIDE
 OUTSIDE
 CEILING HEIGHT 11'-11"
 LIGHTING
 SANITARY FACILITIES

RIVER DIV
 CHAFFEE SUB
 STATION T 191
 3" x 1" Y.P.
 2" x 3/4" Y.P.
 3/4" x 3/4" BEEDED CEILING
 BOARDS & BATT. 1x6 DEEP SIDING
 11'-11"
 ELECTRIC
 OUTSIDE TOILETS

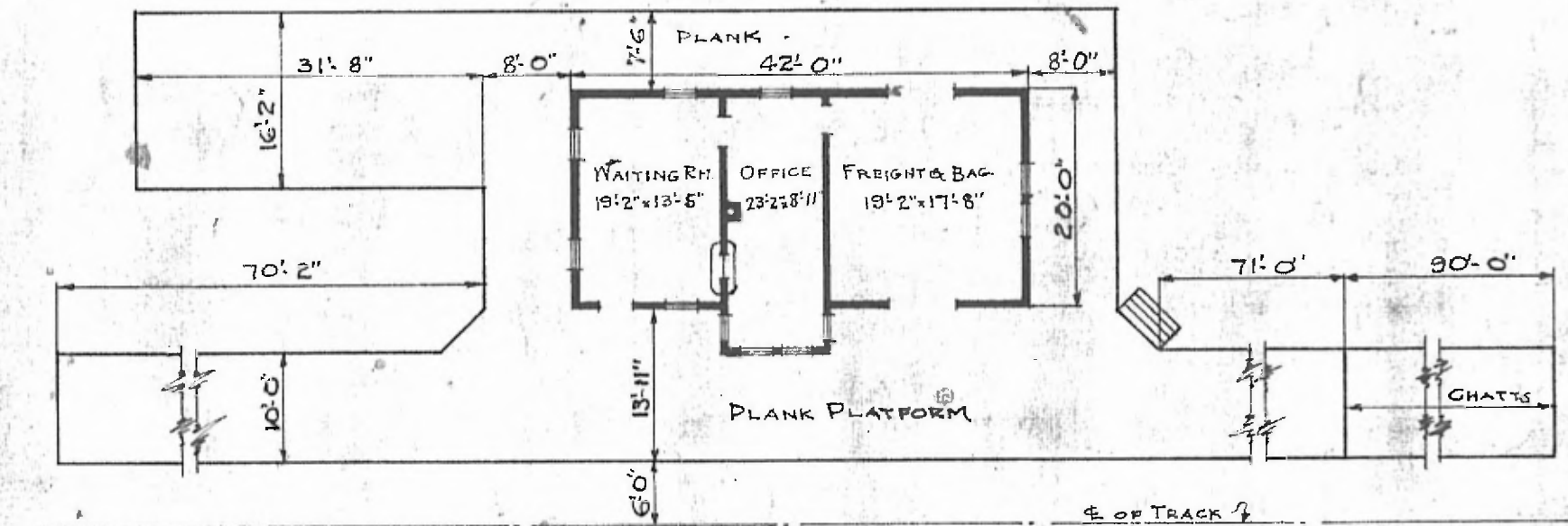

FLOOR PLAN
 SCALE: 1/8" = 1'-0"

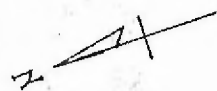

COMBINATION STATION
 MARSTON, MO.

Oct. 3, 1919