

ERECTED TYPE FRAME
FOUNDATION PILE HEADS
WALLS 2"x6"
ROOF TYPE GABLE SHINGLES
PITCH 1/3
HEATING STOVES

FLOOR FINISH { INSIDE
 { OUTSIDE
CEILING HEIGHT 11'-11" - FREIGHT - 13'-1"
LIGHTING OIL LAMPS
SANITARY FACILITIES - OUTSIDE TOILETS.

3/4" x 3/4" Y. PINE
3/4" x 3/4" BD. CEILING
BOARDS & BATTENS

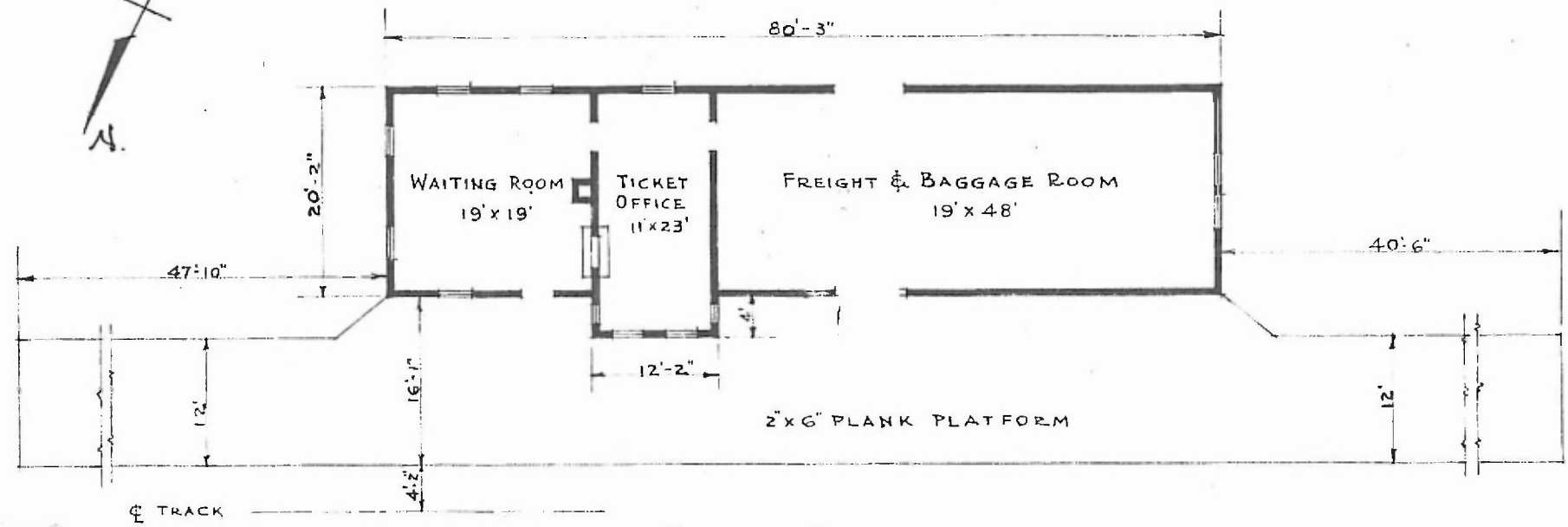

FLOOR PLAN
SCALE: 1/16" = 1'-0"

PASSENGER STATION AT
STEELVILLE MO.