

ERECTED 1890.
 TYPE FRAME.
 FOUNDATION PILE HEADS.
 WALLS 2x6"
 ROOF { TYPE GABLE, SHINGLE.
 PITCH 1/3
 HEATING STOVES.

FLOOR 7/8x3 1/4"
 FINISH { INSIDE 7/8x3 1/4" M+B.
 OUTSIDE BOXING & BATTENS.
 CEILING HEIGHT 11'-5" FR. 11'-5"
 LIGHTING LAMPS.
 SANITARY FACILITIES OUTSIDE.

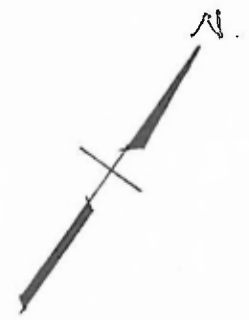
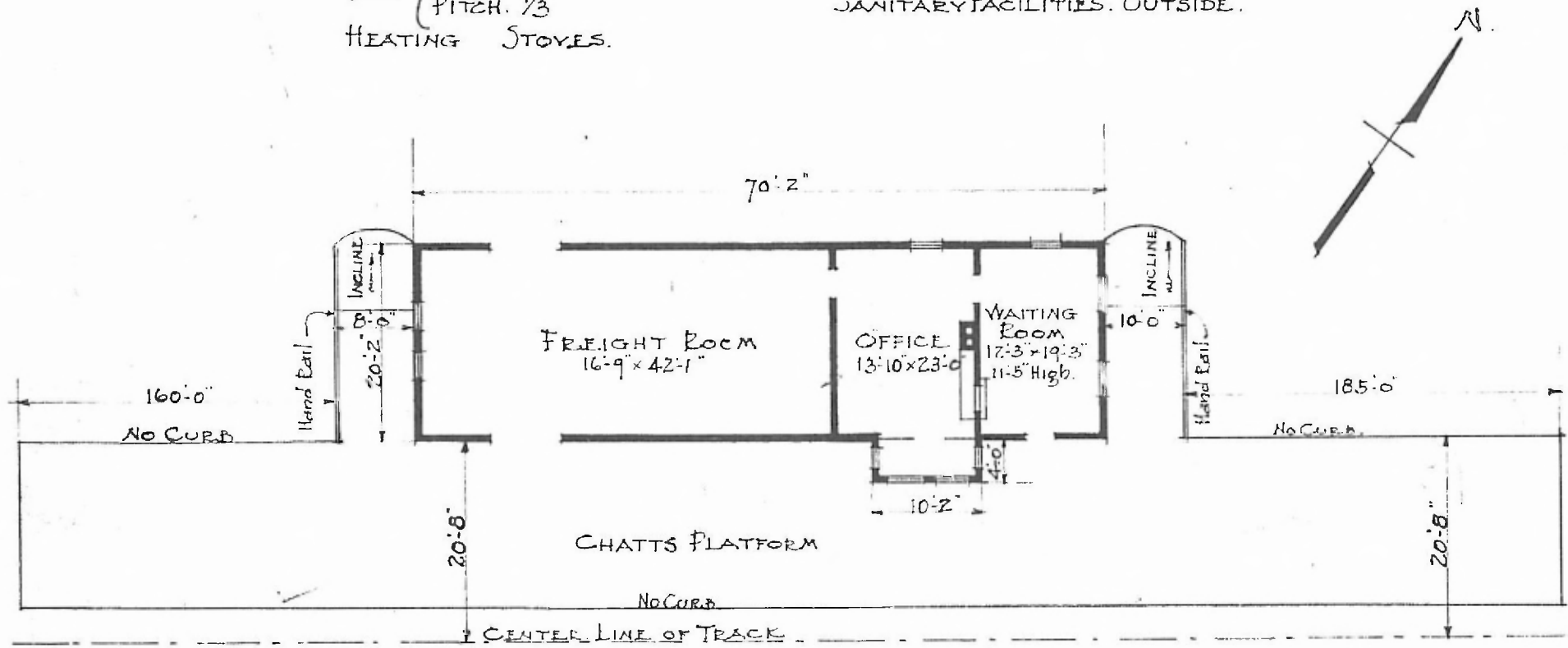

FLOOR PLAN
 SCALE 1/16" = 1'-0"