

ERECTED TYPE FRAME FOUNDATION PILES WALLS 2x4 ROOF TYPE GABLE - SHINGLES PITCH $\frac{1}{2}$ HEATING STOVE

FLOOR FINISH { INSIDE OUTSIDE CEILING HEIGHT 10'-8" LIGHTING OIL SANITARY FACILITIES OUTSIDE TOILETS

SOUTHERN DIV. WILLOW SPRINGS SUB STA. NO. S 332 125

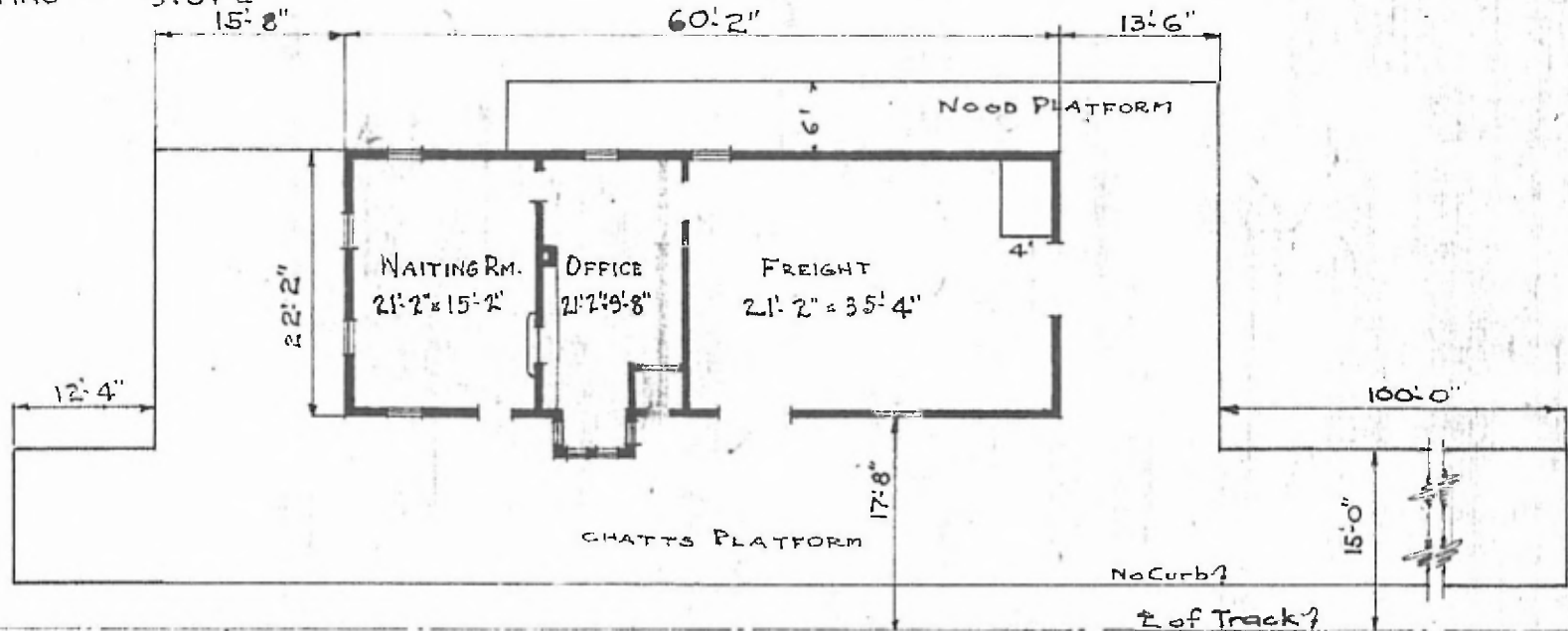

FLOOR PLAN

SCALE: $\frac{1}{16} = 1'-0"$



COMBINATION STATION
WINONA, MO.

SEPT. 13, 1919.